

4" Round Tapered Aluminum

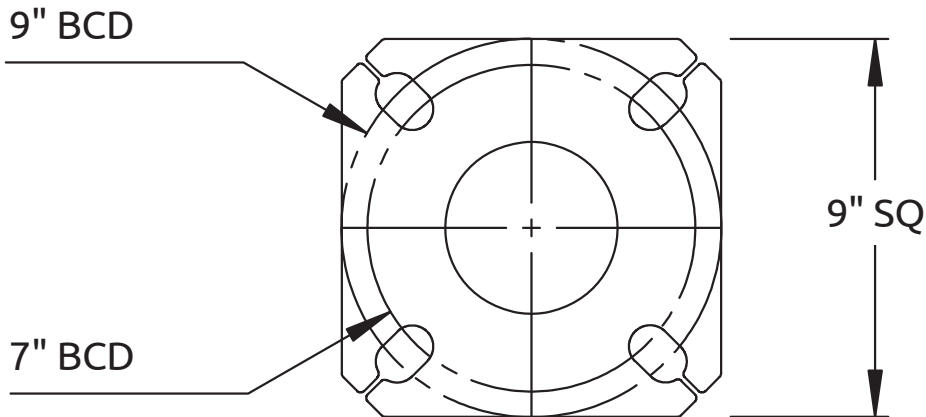

NRTA4 Base

(1" Anchor Bolts)



- Hand hole ring mounting height is 18" to centre and comes with (3"x5") hand hole cover
- Maximum Height is 20ft
- Wind speeds (mph) in the table denote the maximum wind gust speed at the project site (i.e. gust factor included).
- Maximum EPA rating includes fixture(s) and supporting arm(s) and is for standard pole installation on concrete bases/footings.
- Pole designs based on AASHTO Standard Specifications for Structural Supports for Highway Signs, Luminaires, and Traffic Signals.
- Specific information and details may be subject to change without notice.
- Contact Sales Team for custom sizes and/or applications.
- Please see Warranty and Terms & Conditions.

CATALOGUE #			
PROJECT NAME			
CITY			
PREPARED BY		DATE	
CITY			

Catalogue #	Pole Height (ft)	Bottom Diameter (in)	Top Diameter (in)	Pole Type	Anchor Bolt Diameter (in)	Maximum EPA (sq.ft.)			
						100MPH	110MPH	130MPH	150MPH
NRTA410MD	10	4	3	MD	1	10.5	8.5	5.5	4.0
NRTA410HD	10	4	3	HD	1	14.0	11.5	7.5	5.5
NRTA415MD	15	4	3	MD	1	4.5	3.5	2.0	1.0
NRTA415HD	15	4	3	HD	1	6.5	5.0	3.0	2.0
NRTA420MD	20	4	3	MD	1	2.0	1.0	N/A	N/A
NRTA420HD	20	4	3	HD	1	3.5	2.5	1.0	N/A

Pole Type Wall Thickness: XLD = 0.125", LD = 0.156", MD = 0.188", HD = 0.25"