

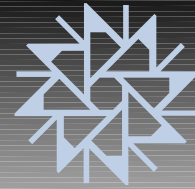

TYPE S POLES

NOVA POLE
INTERNATIONAL INC



Suite 230 - 195 West 2nd Avenue
Vancouver, British Columbia
Canada V5Y 1B8

Phone: (604) 874-8889
Fax: (604) 874-7889

www.novapole.com
email: sales@novapole.com

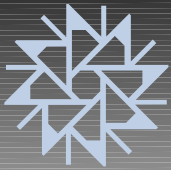

General Specifications

Design

All Nova Pole designs will withstand a gusted wind velocity of 100 MPH (160 km/hr) acting upon the structure with its appropriate fittings (signs, signals and luminaires). Loads and structural dimensions are in accordance with the latest edition of the National Building Code of Canada.

Materials

All materials utilized by Nova Pole meet or exceed C.S.A. standards. Poles are produced using steel, "self-weathering" steel and aluminum.

Welding

All welding done by Nova Pole conforms to C.S.A. Standard W59. Any circumferential welds are 100% penetration with some shaft to baseplates jointed with inside and outside fillet welds, and longitudinal welds have a minimum penetration of 60%.

Finishes

All welders employed by Nova Pole are qualified in compliance to C.S.A. Standards W47 and are approved by the Canadian Welding Bureau.

There are four finishes available for the Tubular Poles:

- 1) Prime Paint
- 2) Enamel Paint
- 3) Hot Dip Galvanizing
- 4) Powder Coat
- 5) Powder Coat over Hot Dip Galvanizing

Accessories

Anchor Bolts

- Available in 24" x 3/4", 36" x 1", 48" x 1 1/4" and 54" x 1 1/2"
- Hot dip galvanized
- Supplied as optional product
- Standard re-Bar conforming to C.S.A. Standard CAN/CSA - G30.18-M Grade 400 for 24" X 3/4". Higher grades for larger sizes.
- Supplied with hexagon nut and washer

Nut & Bolt Cover

- Supplied with pole. Designed to fit 1", 1 1/4" and 1 1/2" bolts.
- High strength polyurethane
- Available in colours

Handhole

- Pole is supplied with 4" x 7" handhole, grounding stud and handhole cover

The standard tenon size is 2 3/8" O.D. by 7" long.

Any designs not shown in this catalogue can be produced by Nova Pole International and inquiries should be communicated to company representatives.

Approval drawings are available on request.

All measurements shown here are imperial measure (inches, square inches and feet) unless otherwise noted.

Tenon
Special Orders

Approval Drawings
Measure



Type S Signal Arms



SHAFTS, ARMS & EXTENSIONS

DAVITS

Cat. #	Hwy. SN	Height m	Reach m	Weight kg
TYPE 2A	1832	2.5	2.5	35
TYPE 2C	1833	2.5	2.5/2.5	65

See page 16 for details

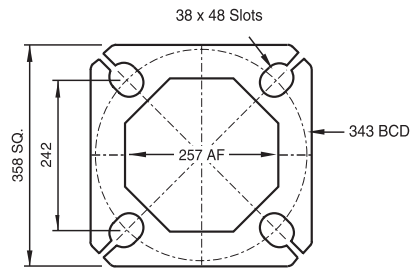

BASE PLATE - PLAN VIEW
FOR TYPE S SHAFTS

SHAFTS

Cat. #	Height m	Weight kg	BCD mm	Anchor Bolt Dia. mm
TYPE S	6.75	386	343	25 (1" \varnothing DYWIDAG A/Bolts)

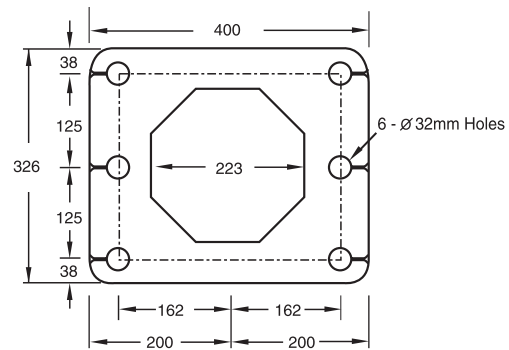

ARM FLANGE
FOR TYPE S SHAFTS

SIGN ARM EXTENSIONS

Cat. #	Reach m	Weight kg
TYPE 3SS	3.0m	135
TYPE 4SS	4.0m	180
TYPE 5SS	5.0m	225

SIGNAL ARMS

Cat. #	Reach m	Weight kg
TYPE 5.0S	5.0m	131.8
TYPE 5.5S	5.5m	141.8
TYPE 6.0S	6.0m	151.8
TYPE 6.5S	6.5m	161.8
TYPE 7.0S	7.0m	171.8
TYPE 7.5S	7.5m	182.0
TYPE 8.0S	8.0m	192.2
TYPE 8.5S	8.5m	256.2
TYPE 9.0S	9.0m	269.6
TYPE 9.5S	9.5m	283.0
TYPE 10.0S	10.0m	296.4
TYPE 10.5S	10.5m	309.7

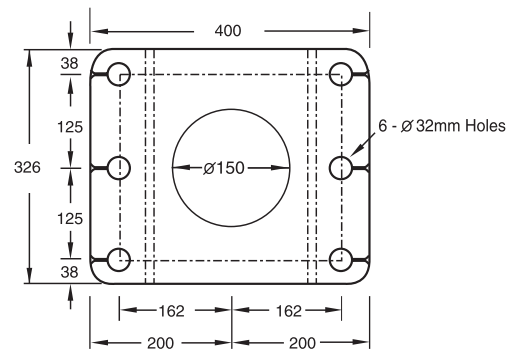

SHAFT FLANGE
FOR TYPE S SHAFTS

PLEASE NOTE:
ALL MEASUREMENTS SHOWN ARE METRIC

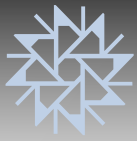

NOVA POLE
INTERNATIONAL INC

Type S Signal Arms

SHAFTS, ARMS & EXTENSIONS

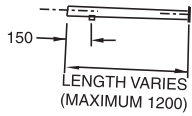

TYPE L SIGN ARM

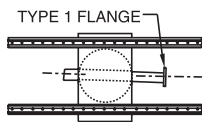

**TYPE LB SIGN KIT
FRONT VIEW**

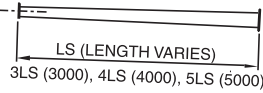

**TYPE LS 3LS 4LS 5LS
SIGN ARM EXTENSIONS**

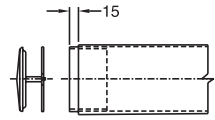

**PLASTIC END CAP
MOUNT DETAIL**

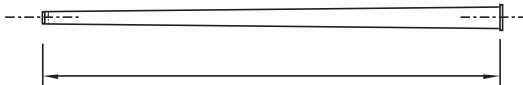

**TYPE 5.0S, 5.5S, 6.0S, 6.5S, 7.0S, 7.5S
8.0S, 8.5S, 9.0S, 9.5S, 10.0S, 10.5S
SIGNAL ARM**

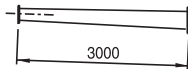

TYPE 3SS EXTENSION

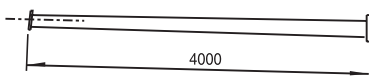

TYPE 4SS EXTENSION

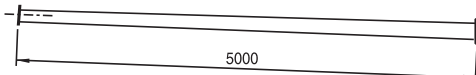

TYPE 5SS EXTENSION

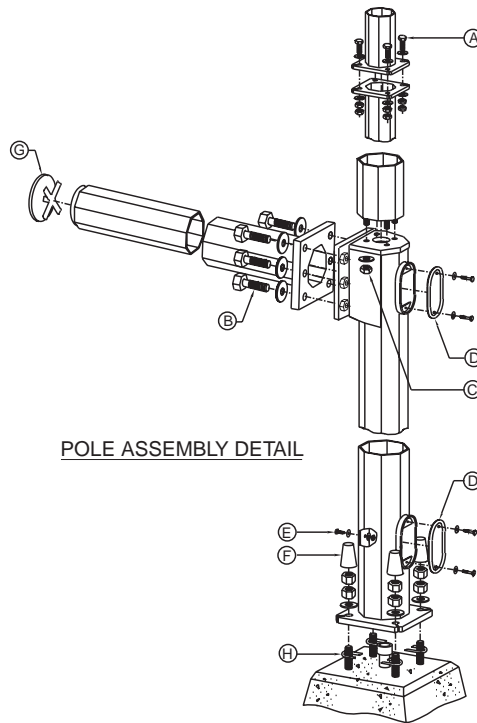

POLE ASSEMBLY DETAIL

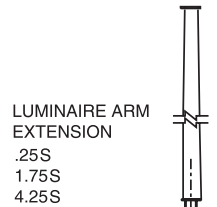

**LUMINAIRE ARM
EXTENSION
.25S
1.75S
4.25S**

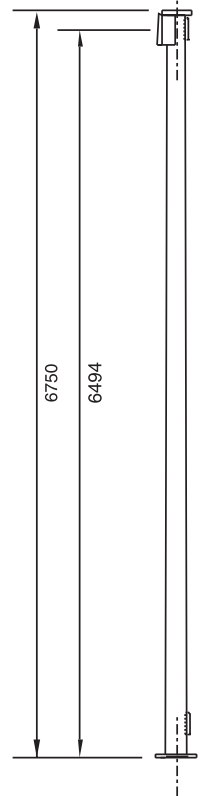

TYPE S SHAFT

PLEASE NOTE:
ALL MEASUREMENTS SHOWN ARE METRIC

