

4" Straight Round Aluminum

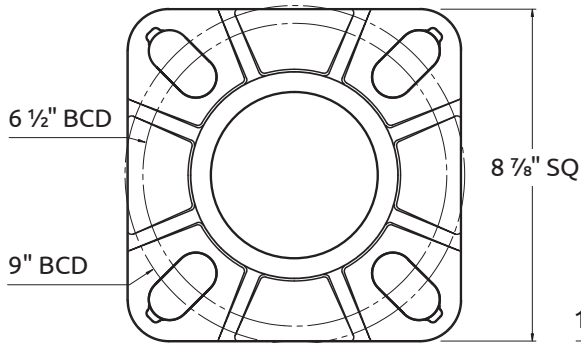

NSRA Type A
 (3/4" x 24" or 1" x 24" Anchor Bolts)
Default Base Plate Option

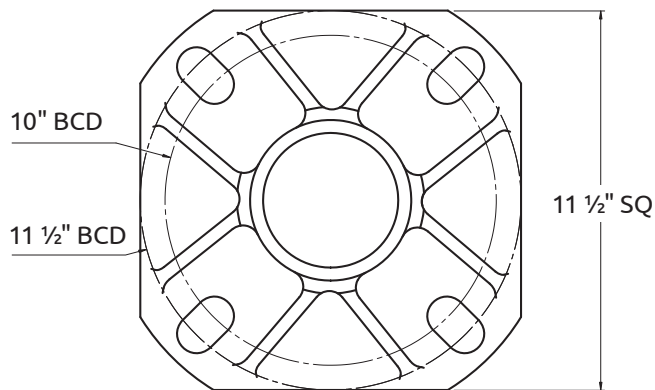

NSRA Type A2
 (1" x 24" Anchor Bolts)
Select A2 Base Plate in Options column on reverse page





- If supplied, the festoon box is installed at 5m height. Notify Nova Pole if different mounting height is required.
- Hand hole ring mounting height is 12" to centre and comes with (3"x5") hand hole cover
- Wind speeds (mph) in the table denote the maximum wind gust speed at the project site (i.e. gust factor included).
- Maximum EPA rating includes fixture(s) and supporting arm(s) and is for standard pole installation on concrete bases/footings.
- All poles are supplied with nut covers, shims and top plastic cap.
- Pole designs based on AASHTO Standard Specifications for Structural Supports for Highway Signs, Luminaires, and Traffic Signals.
- Contact Sales Team for custom sizes and/or applications.
- Specific information and details may be subject to change without notice.
- Please see [Warranty](#) and [Terms & Conditions](#).

CATALOGUE #	
PROJECT NAME	
CITY	
PREPARED BY	DATE
COMMENTS	

FIXTURE INFO	
QUANTITY	
EPA (sq.ft.)	
WEIGHT (lbs)	

Catalogue #	Pole Height (ft)	Pole Weight (lbs)	Pole Type	Anchor Bolt Size	Base Plate Type	Maximum EPA (sq.ft.)			
						80MPH	90MPH	100MPH	110MPH
NSRA408LD	8	19	LD	3/4" x 24"	A	7.9	6.0	4.7	3.9
NSRA408MD	8	29	MD	3/4" x 24"	A	16.6	12.9	10.4	8.5
NSRA410LD	10	22	LD	3/4" x 24"	A	5.9	4.3	3.3	2.7
NSRA410MD	10	35	MD	3/4" x 24"	A	12.8	9.9	7.9	6.5
NSRA412LD	12	26	LD	3/4" x 24"	A	4.3	3.0	2.2	1.7
NSRA412MD	12	41	MD	3/4" x 24"	A	10.2	7.7	6.2	5.0
NSRA414LD	14	30	LD	3/4" x 24"	A	3.0	1.9	1.2	0.9
NSRA414MD	15	47	MD	3/4" x 24"	A	7.9	5.9	4.6	3.7
NSRA416LD	16	33	LD	3/4" x 24"	A	1.9	1.0	0.5	0.2
NSRA416MD	16	53	MD	3/4" x 24"	A	6.0	4.3	3.4	2.6
NSRA418MD	18	59	MD	3/4" x 24"	A	4.5	3.1	2.3	1.8

Order Entry Info				
HEIGHT (ft)	MOUNTING TYPE <i>(See Note 1)</i>	FINISH TYPE	PC COLOUR	OPTIONS <i>(Click descriptions to view product)</i>
8 (LD)	 TOP TENON MOUNT TT238 - 2 3/8" x 5" tenon TT278 - 2 7/8" x 5" tenon TT350 - 3 1/2" x 5" tenon	PC - Powder Coated NTPC - Nova Tuff Powder Coated <i>(Colour Chart)</i> <i>For Powder Coated, please select Colour from next column</i>	WHT - White (RAL-9003) BLK - Black (BK50) DBZ - Dark Bronze (RAL-8019) GRY - Grey (RAL-7040) GRN - Green (RAL-6005) CC - Custom Colour (RAL-) <i>(Additional charges may apply)</i> BR - Brushed N - None <i>For Nova Tuff, please provide RAL# under CC</i>	<input type="checkbox"/> DUPR - 1110 Box Provision (Festoon Box) <input type="checkbox"/> DUPRGI - 1110 Box Provision c/w 15A 120V GFI Receptacle and Weatherproof Cover <input type="checkbox"/> BPA2 - A2 Base Plate (10" to 11 1/2" BCD) <input type="checkbox"/> BCP - Type 4 Plastic Base Cover <input type="checkbox"/> BCCS - Type 4 Cast Square Base Cover <input type="checkbox"/> BCCR - Type 4 Cast Round Base Cover <input type="checkbox"/> HHSS - Hand Hole Security System <input type="checkbox"/> FBA1 - Flower Basket Arm One Side <i>(See Note 2)</i> <input type="checkbox"/> FBA2 - Flower Basket Arm Dual <i>(See Note 2)</i> <input type="checkbox"/> BA1 - Banner Arms One Side <i>(See Note 3)</i> <input type="checkbox"/> BA2 - Banner Arms Dual <i>(See Note 3)</i> <input type="checkbox"/> AB - Anchor Bolts <input type="checkbox"/> BH - Bullhorns <input type="checkbox"/> N - None
8 (MD)				
10 (LD)	 SIDE TENON MOUNT <i>Dimensions: 2 3/8" dia. x 5" long</i> ST1 - Single Head ST2180 - 2 Heads at 180 ST290 - 2 Heads at 90 ST390 - 3 Heads at 90 ST3120 - 3 Heads at 120 ST490 - 4 Heads at 90	<i>For Powder Coated, please select Colour from next column</i>		
10 (MD)				
12 (LD)	 DRILL PATTERN DP1 - Single Head DP2180 - 2 Heads at 180 DP290 - 2 Heads at 90 DP390 - 3 Heads at 90 DP3120 - 3 Heads at 120 DP490 - 4 Heads at 90			
12 (MD)				
14 (LD)	N - None			
14 (MD)				
16 (LD)				
16 (MD)				
18 (MD)				
Height	Mounting	Finish Type	PC Colour	Options
NSRA4				

Pole Type Wall Thickness: LD = 0.125", MD = 0.188", HD = 0.250"

Sample Catalogue #: NSRA416MD-ST1-PC-BLK-HHSS-BA1

Note 1: Please provide fixture cutsheet.

Note 2: Please provide basket weight, arm length and mounting height.

Note 3: Please provide banner size and mounting height.

[Reset Order Entry Form](#)